

Da 400A a 1500A con secondario 1A o 5A
From 400A to 1500A with secondary 1A o 5A

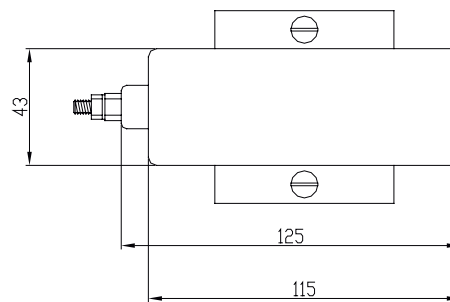

Corrente primaria: **400÷1500 A**
Corrente secondaria: **1 o 5 A**
Grado di protezione: **IP00**
Rigidità dielettrica: **3kV/50Hz x1'**
Classe di isolamento: **F**
Classe termica: **F**
Massima corrente di sovraccarico:
+15% costante
Frequenza: **50-60Hz**
Fissaggio: **Su barra**

Primary current: **400÷1500 A**
Secondary current: **1 o 5 A**
Degree of protection: **IP00**
Dielectric strength: **3kV/50Hz x1'**
Insulation class: **F**
Thermal class: **F**
Maximum Overload current: **+15% constant**
Frequency: **50-60Hz**
Fixing: **On Bar**

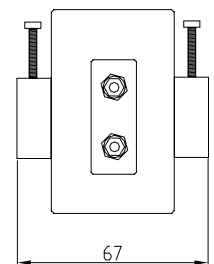
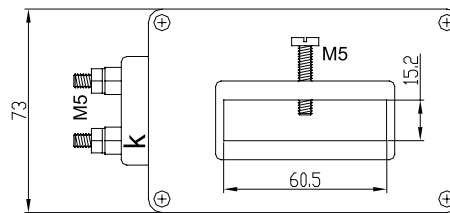

Codice Code	Correnti Amperometriche Current amperometric		Prestazione Performance		Dimensioni barra o cavo Size bar or cable	Pronto a magazzino Shelf Ready	Pronto in 7gg Ready in 7 days
	Primario (A) Primary (A)	Secondario (A) Secondary (A)	VA	Classe Class			
TA4.400.1.1	400	1	3	1	60x15	NO	SI
TA4.400.5.1		5					
TA4.500.1.1	500	1	5				
TA4.500.5.1		5					
TA4.600.1.1	600	1	10				
TA4.600.5.1		5					
TA4.800.1.1	800	1	15				
TA4.800.5.1		5					
TA4.1000.1.1	1000	1	25				
TA4.1000.5.1		5					
TA4.1200.1.1	1200	1	30				
TA4.1200.5.1		5					
TA4.1500.1.1	1500	1	30				
TA4.1500.5.1		5					